



ZERO CAVITY
MODULE
NDS-CCD
NDD-CCD

Module for the application of adhesive beads. Prevents clogging. Eliminates small impurities automatically. Sharp cutoff in the application. Perfect closure without cavity in the nozzle. With removable nozzle. Easy selection of outlet diameter.

GLUING
SOLUTIONS

- These modules are intended for assembly on the NC applicator series.
- Versions:
 - NDS-CCD (air open- spring close)
 - NDD-CCD (air open- air close)
- The fit with the needle on the nozzle tip is cavity free. In addition, the high resistance to wear and deformation of the needle guarantees a high module durability.
- The nozzle can be removed and used with various outlet diameters.
- The optional micrometric adjustment for the NDS.CCD module can be used to:
 - Reduce adhesive flow.
 - Adjust to small changes in multi-module applicators.

PRIMARY USES: High-frequency packaging, graphic arts and any application that requires a perfect cut for the adhesive and absence of adhesive strips.

These modules are also compatible with applicators from other brands.

TECHNICAL CHARACTERISTICS

Max. temperature	200°C
Max. hydraulic pressure	80 bar (1160.3 psi)
Pneumatic pressure	4-5.5 bar (58-80 psi)
Max. working frequency	4800 cycles/min in serie NC applicator
Nozzle diameter	0.20/0.30/0.40/0.50/0.60/0.80/1.00
Setting of micrometric adjustment	1.4 mm (> 50% max. flow)

(* According to outlet diameter and working conditions.

DIMENSIONS

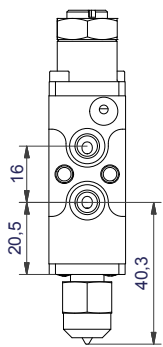

NDS-CCD

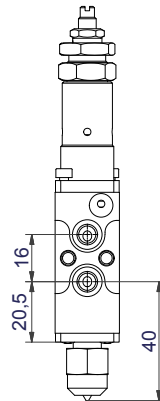
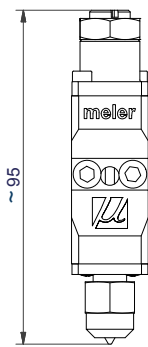
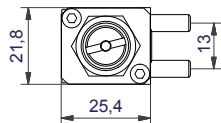
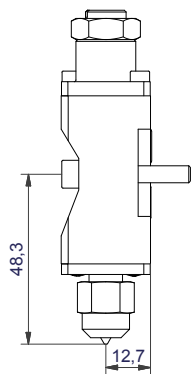

NDS-CCD-R

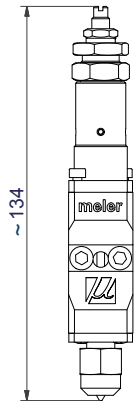
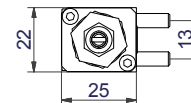
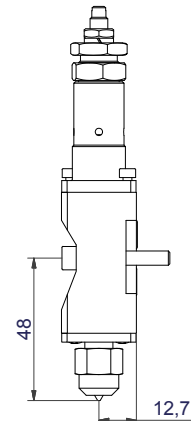

NDD-CCD

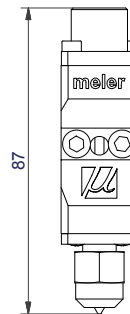
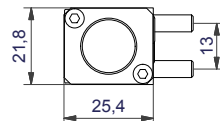
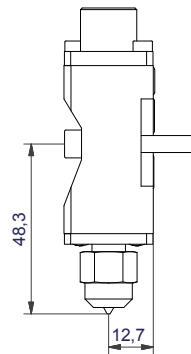
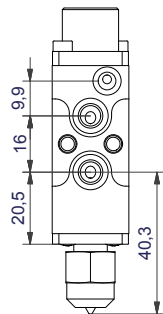

For more information speak with your Meler representative:

meler 

GLUING SOLUTIONS

Head Office

Pol. Los Agustinos, c/G, nave D-43
E-31160 Orcoyen - Navarra - Spain
Phone: +34 948 351 110
Fax: +34 948 351 130
email: info@meler.eu

www.meler.eu

